



Sign Lighting World
720-242-900
Sales@signLightingWorld.com
www.SignLightingWorld.com



S-4120-XXXX



◆ Features

- ✧ Constant Current Technology, 30 pcs per series
- ✧ Exposed Aluminum plate for heat dissipation
- ✧ Injection molding process, Water proof: IP 67
- ✧ High efficiency chip, high brightness and reliability
- ✧ Energy saving, Environment friendly
- ✧ Long life span
- ✧ Suitable for channel letters and light boxes back lighting etc.

◆ Applications

- ✧ Channel letter lighting
- ✧ Commercial standing lighting
- ✧ Letter background lighting
- ✧ Light box lighting
- ✧ Logo lighting
- ✧ Line/shape lighting

◆ Dimensions

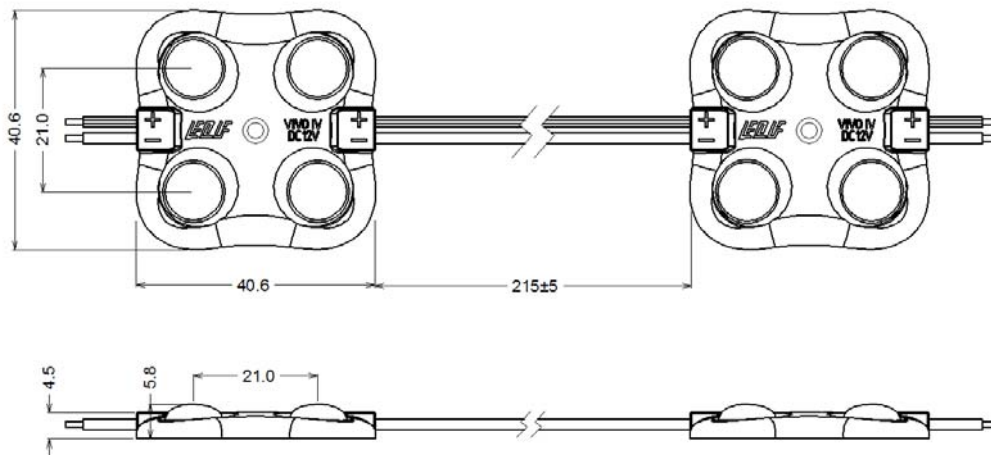

◆ Technical parameters

Part No.	Color	Wave Length or CCT	Operating Voltage	Rated Power per module	Beam Angle	Lm Flux per module	IP Rate
S-4120-CW	Cool White	5500-7500K	DC12V	1.2W	160°	105 lm	IP67
S-4120-WW	WarmWhite	2700-3200K	DC12V	1.2W	160°	100 lm	IP67



◆ Distribution curve

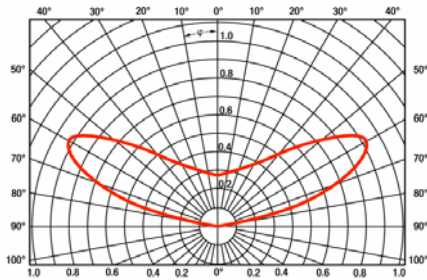

◆ Application Guide



1. Maximum number of modules per chain is 30pcs from power supplier to single end.
2. The parameters may change as the type of material of lighting boxes or channel letters.
3. The LED module including its components can't be mechanical stressed.
4. Please ensure that the power supply is adequate power to operate the total load.
5. Only professionals can tear down, install or maintain LED modules.
6. All of box materials used for installation have to meet anti-flame rules and related so on.
7. Power supply should be short circuit and overloading protection, and total power should be less than rated power 80% of that power.
8. Working temperature: -25~55°C.